



Artful Thinking

Experience Change With Artful Thinking

3D Beaked Masks



Materials: PVA Glue, scissors, coloured card, masking tape/cello tape, markers, tissue paper/coloured paper, elastic string, hole puncher (optional)

Choose the base mask colour, we chose blue. Then fold over the a4 card, and draw your mask outline on one side, with the fold placed on the inside, and non-folded side is where the details will be cut.

Hold folded card to your face and on the other side lightly mark where your eye is, then cut.

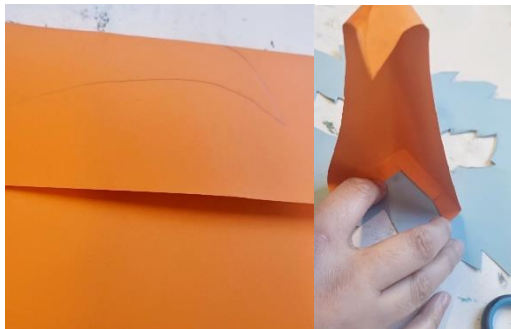
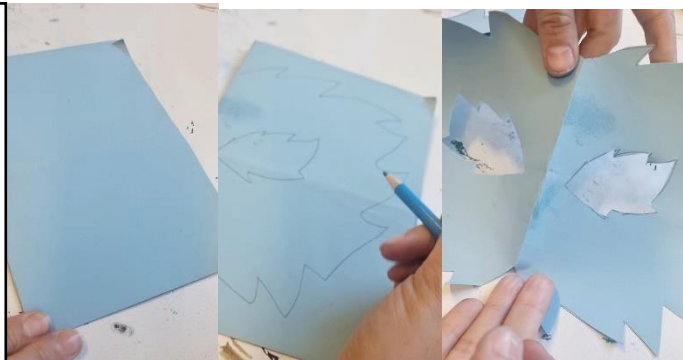

Now choose what beak colour your would like. Fold a part of your card, then draw out the beak.

Cut this out, then using glue overlap and fold the pointed beak end then cut "flaps" in base and after folding these glue or tape to your mask.

Choose what coloured paper you would like to use for the feathers, then fold these pages back over themselves multiple times, then cut "leaf" shapes, then cut slits into these, so they resemble feathers.

Using different tones/shades of markers add more details to your feathers.





Now using glue, begin to build and layer your feathers onto the mask. Having feathers of varying sizes is handy to help create a denser packing of feathers.

Add as little or as much as you would like.



We hope you had fun building your different masks or recreating the craft by modifying it.

We'd love to see what you made, you can post your images on social media and tag us!

<https://www.facebook.com/ArtfulThinkingUK/> or our Instagram @artfulthinkinguk