



# Artful Thinking

Experience Change With Artful Thinking

## Monster Plants



**Materials:** Air Dry clay, malleable garden wire, wire cutters, clay tools, paints, varnish (or PVA glue), paint brushes.

Cut approximately 40cm of garden wire, you need to make a loop for the “bottom” end, this will be the bottom of your pot. Then wrap the wire over itself to secure it. When thinking about your monster plants head that will be a smaller loop on the other end.

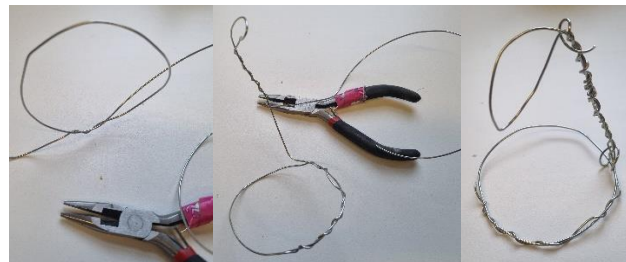

Now take out some clay, roll pieces into snakes and weave them around the shape of the wire base and begin to mould it with your fingers.

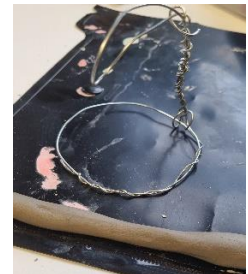

Once the wire base is covered think about what shape your monsters head will take. Make sure as you go you smooth the gaps or lines between the layers.



Make petals by rolling small pieces of clay in your hands, flattening them between your fingers, and pinching the ends and attach them to the head of your monster plant.

Make sure to smooth over any gaps or edges between the layers, petals, or leaves.



Make leaves and add other details to your plants, then leave to dry, takes 2-3 days depending on where you leave it (sunshine helps!!).



Now paint or leave it blank, whatever you'd prefer. If deciding to paint make sure to take your time (and have lots of fun) mixing up colours, layering them and choosing which colours that contrast or compliment.

